

# HX STOMP XL CHEAT SHEET



Full HX Stomp™ XL Owner's Manual at [line6.com/support/manuals](http://line6.com/support/manuals)

Video tutorials available at [line6.com/meet-hx-stomp-xl](http://line6.com/meet-hx-stomp-xl)

## LOST?

Press to exit all the way out

Press to toggle between **PLAY VIEW** and **EDIT VIEW**

## PLAY VIEW

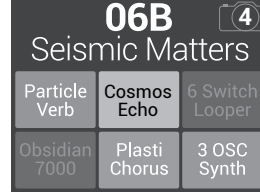

## EDIT VIEW

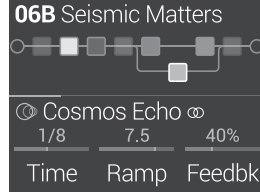

## VOLUME

Turn to control level from 1/4" Main and Headphone outputs  
Press to recess into chassis

## Upper Knob

**PLAY VIEW:** Turn to select presets

**EDIT VIEW:** Turn to select blocks

Press to bypass selected block

## ACTION

Press to open action panel for selected block or menu (move, copy, paste, clear, etc.)

Press + ACTION to save preset

## Lower Knob

**EDIT VIEW:** Turn to change model

Press to open model list

## ◀ PAGE ▶

**EDIT VIEW:** Press to view more parameters for the selected block or item

Press PAGE to open menu with advanced functions and settings

## Knobs 1-3

**EDIT VIEW:** Turn to adjust parameters for the selected block  
Press to reset value

Press to toggle between Hz or ms and note values

Press and hold to jump to the Controller Assign page for that parameter

Press and turn to assign the parameter to snapshot control

Hold ACTION and press knob to unassign any controller

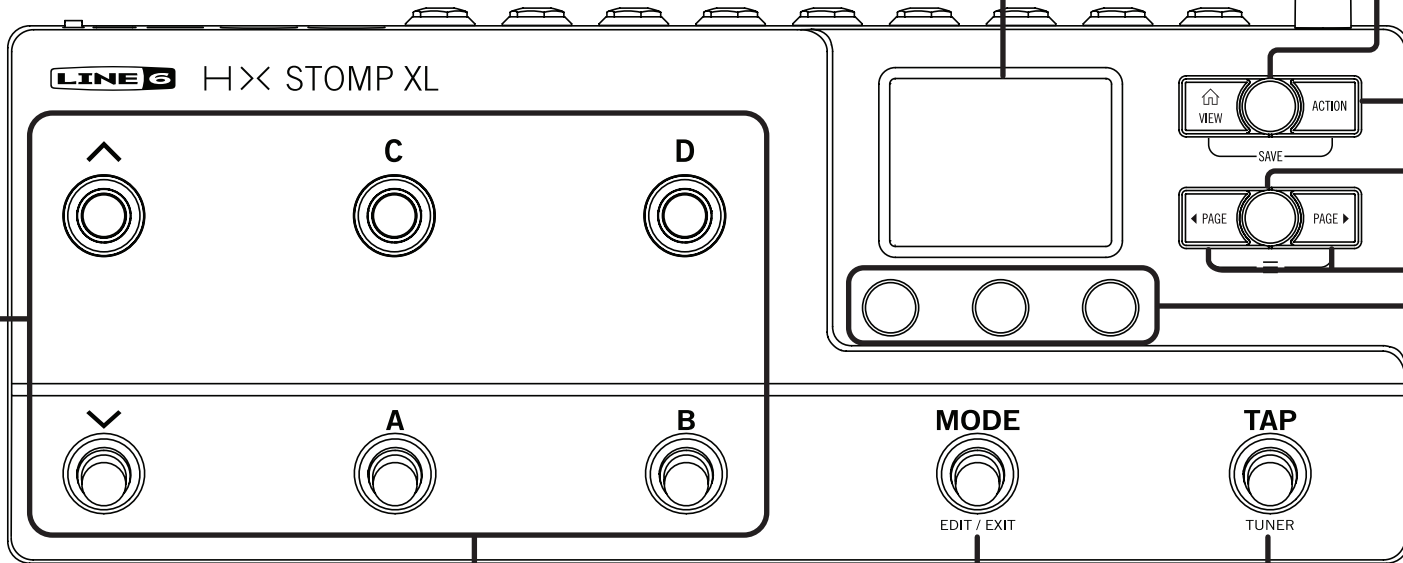

## PRESET Footswitches

Step on footswitches A, B, C, or D to select a preset

Step on / to select the next/previous bank of presets

Press both and to enter Snapshot Footswitch Mode

Hold both and to cycle through Bank, Preset, and Snapshot Up and Down

## STOMP Footswitches FS1-FS6

Step on a footswitch to toggle its effects on and off

Touch a footswitch to assign to the selected block

Touch repeatedly to cycle through multiple assigned items

Touch-hold two switches to swap assignments

## MODE

Step on MODE to toggle between Preset and Stomp Footswitch Modes

Hold for Pedal Edit mode (edit effects with your feet)

## TAP/TUNER

Step on TAP to set tempo

Hold to open the Tuner

**EDIT VIEW:** Touch to open Tempo panel

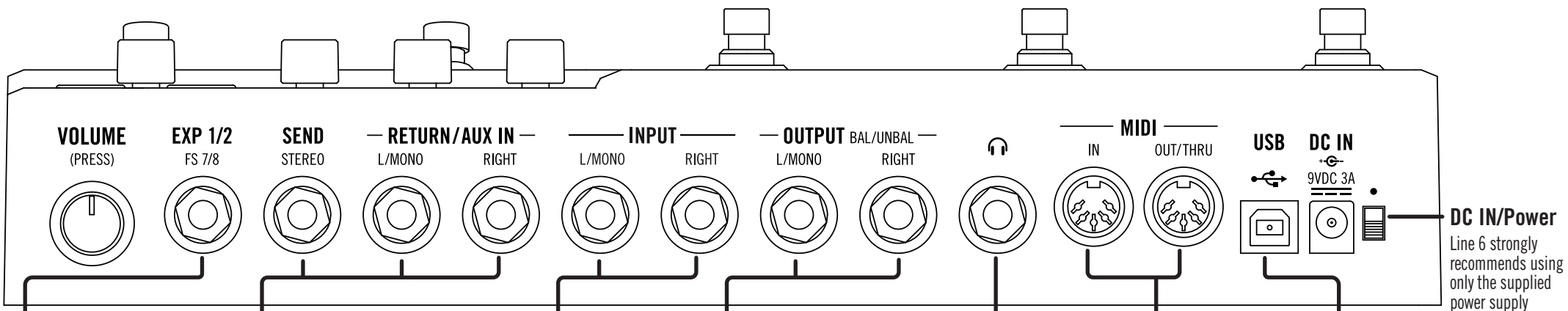

**EXP 1/2, FS 7/8**

Connect an expression pedal or momentary footswitch here; use a Y cable to connect two pedals, two switches, or one of each

**SEND, RETURN/AUX IN**

Can be used as a mono or stereo FX Loop for inserting external stompboxes into your tone or to connect your amp via 4-Cable Method (see hookup diagram below)  
Returns can be globally set to act as an always-on stereo Aux input

**INPUTS**

Connect your guitar, bass, or synth here; when connecting a mono instrument, use the L/MONO input

**OUTPUTS**

Connect to other pedals or your guitar amp(s); when connecting to a mono pedal or single amp, use the L/MONO output  
Use 1/4" TRS > XLR Male cables to run balanced signals to a mixing console

**Phones Out**

Connect headphones here; turn VOLUME knob to adjust level

**MIDI IN, OUT/THRU**

Connect to your MIDI gear for sending and receiving program changes and other MIDI messages

**USB**

Connect to your computer for editing via HX Edit, updating the firmware  
HX Stomp XL functions as an audio and MIDI interface with re-amping built in

**HX STOMP XL AS EFFECTS PEDAL**

Presets starting with "FX"

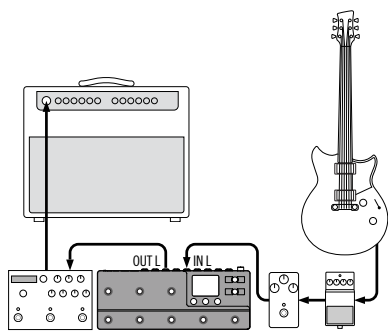

**HX STOMP XL IN 4-CABLE METHOD**

Presets starting with "4CM"

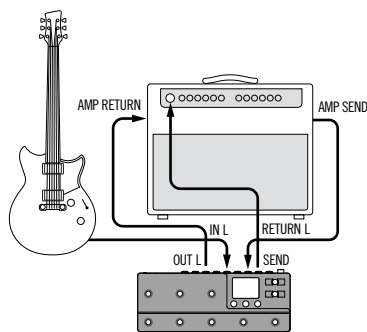

**HX STOMP XL DIRECT TO POWERED SPEAKER(S)**

Presets starting with "DIR"

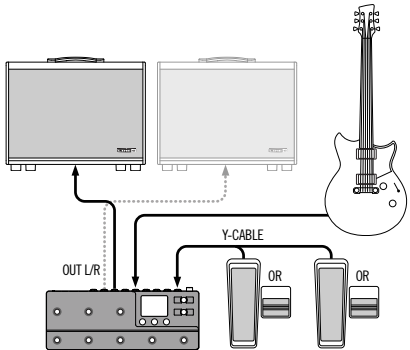

**HX STOMP XL AS HYBRID BASS RIG**

Presets starting with "BAS"

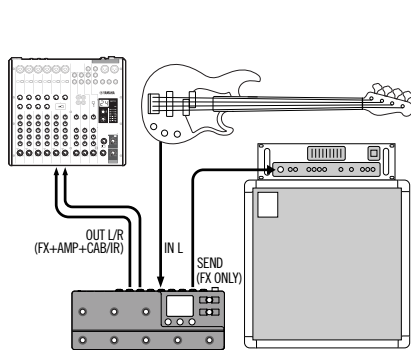

**HX STOMP XL AS STUDIO INTERFACE**

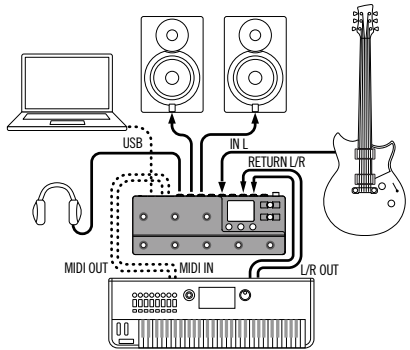

Serial No: \_\_\_\_\_