

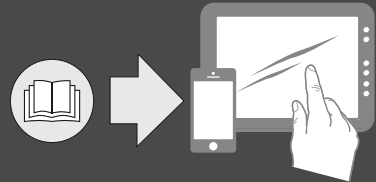

ew 100 G4

- Quick Guide
- Kurzanleitung
- Guide rapide
- Guida rapida
- Guía de inicio rápido
- Guia rápido
- Beknopte handleiding
- Krótka instrukcja obsługi
- Snabbguide
- Kort vejledning
- Рiкaohje
- Γρήγορος οδηγός
- Kısa Kılavuz
- Краткая инструкция
- 快速指南
- 快速使用指南
- クイックガイド
- 퀵 가이드

SENNHEISER



Sennheiser Documentation App



ANDROID APP ON Google play

Available on the App Store

or online at www.sennheiser.com/download
ew 100 G4_

Sennheiser electronic GmbH & Co. KG

Am Labor 1, 30900 Wedemark, Germany
www.sennheiser.com

Publ. 03/18, 575860/A02

EM 100



SK 100



SKM 100

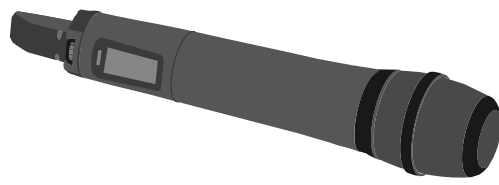

SKM 100-S

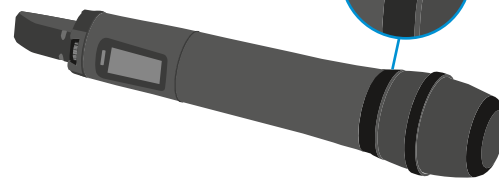

Battery

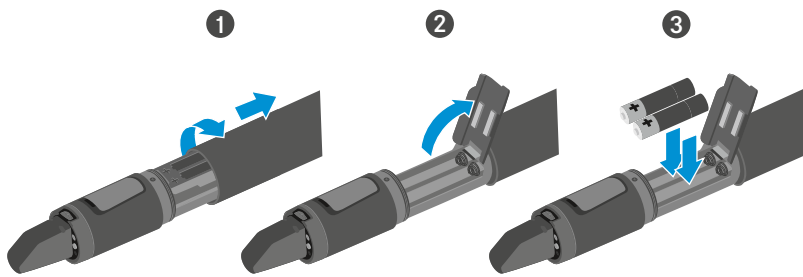

Low Battery

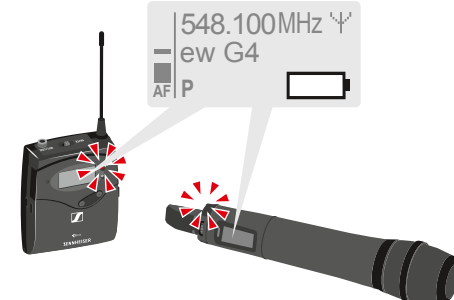
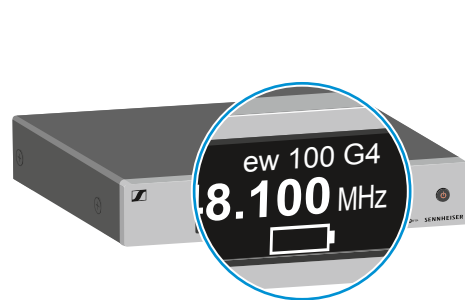

	100 %	> 8 h
	70 %	4 - 6 h
	30 %	2 - 3 h

LOW BATT

Setup

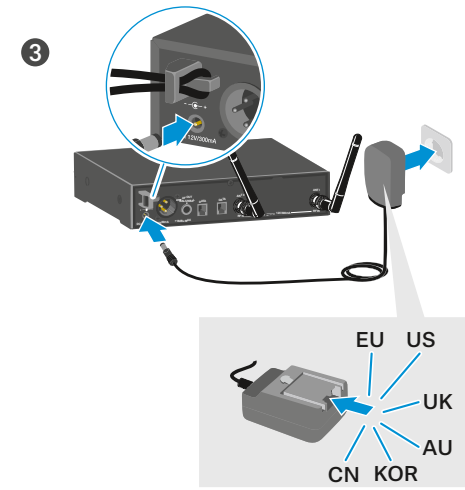
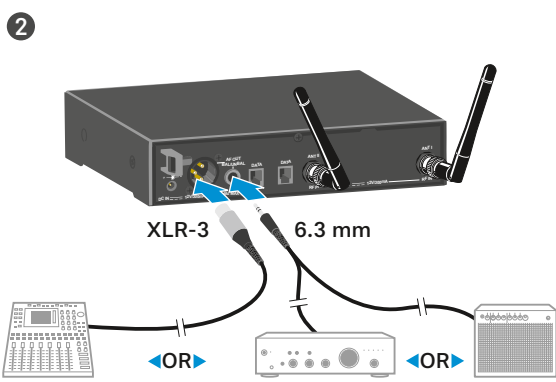
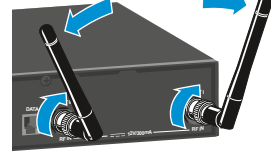

On

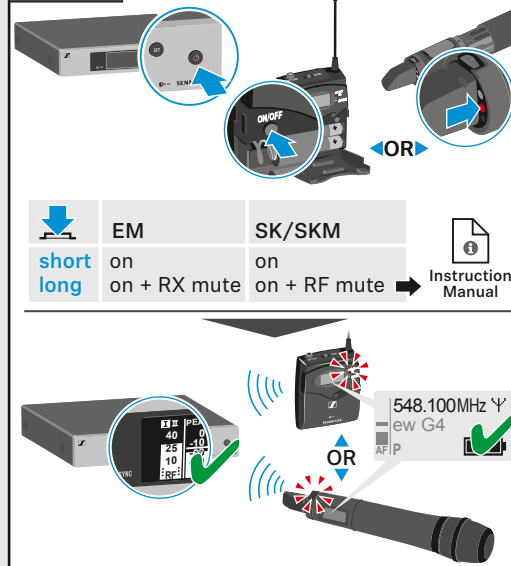

Off

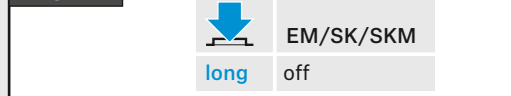

Menu

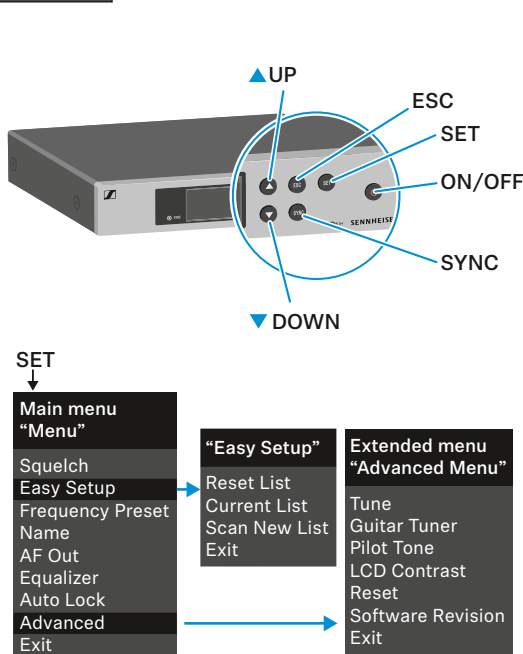

Standard display

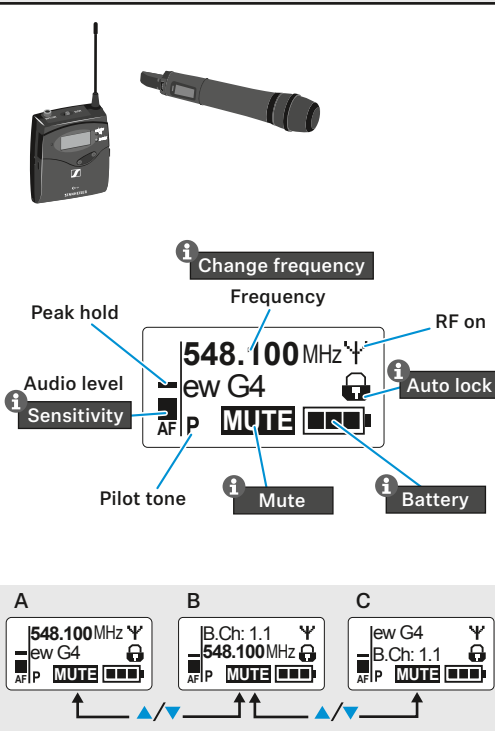
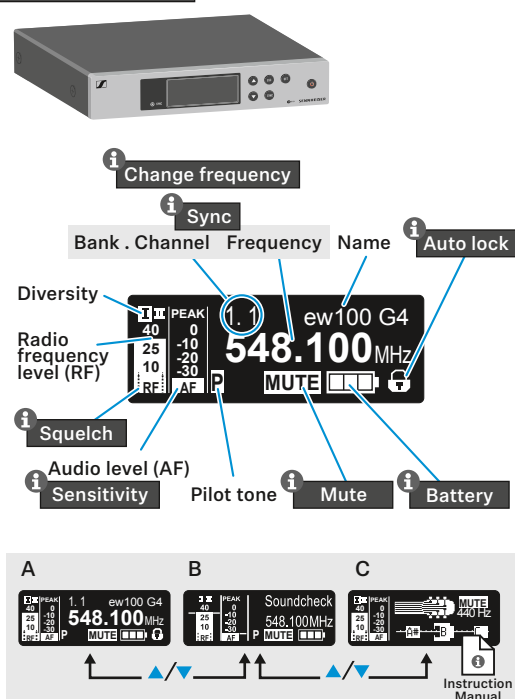

Menu

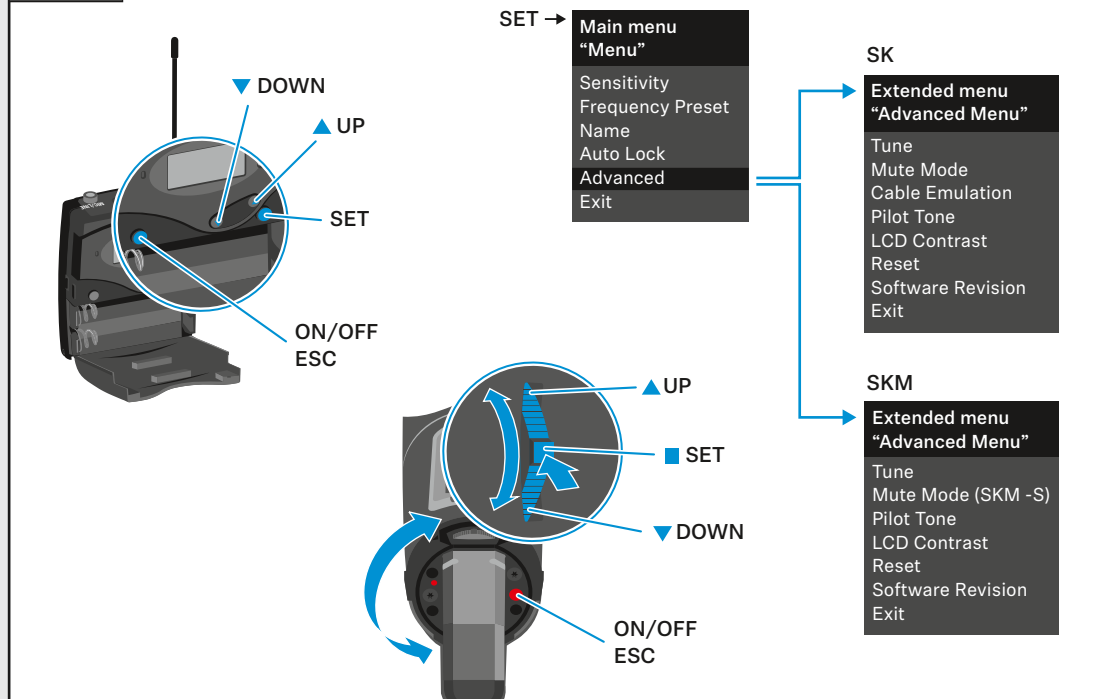

Auto lock

EM

- 1
- 2
- 3

Locked Δ/∇ Unlock?

SET Δ/∇ SET

SK

- 1
- 2
- 3

Locked Δ/∇ Unlock?

SET Δ/∇ SET

SKM

- 1
- 2
- 3

Locked \square Unlock?

SET \square SET

10 s → Auto lock

Instruction Manual

Mute

Instruction Manual

short

RX Mute On?

RX Mute Off?

SET

EM 100

SKM 100

short

RF Mute On?

RF Mute Off?

SET

New frequency

Squelch

- 1

High 40

Middle 25

Low 10

RF

SK 100

SKM 100-S

Menu Advanced Δ/∇ SET

Advanced Mute Mode Δ/∇ SET

Mute Mode AF On/Off Δ/∇ SET

SK only: Mute Mode RF On/Off Δ/∇ SET

AF Mute

Mute On

Mute Off

RF Mute

Mute On

Mute Off

Change frequency

2 SKM/SK off!

3

Easy Setup EM	Frequency Preset EM, SK, SKM
Menu Easy Setup Δ/∇ SET	Menu Frequency Preset Δ/∇ SET B.Ch: 1.1
Easy Setup Scan New List Δ/∇ SET	Frequency Preset Δ/∇ SET B.Ch: 15.6 767.900 MHz
Scan New List 734...776 MHz WAIT 30s	Frequency Preset Δ/∇ SET B.Ch: 15.6 767.900 MHz
Easy Setup Bank 1...20 Δ/∇ SET Free: 0...12	Stored
Easy Setup B.Ch: 1...12 Δ/∇ SET Sync 758.200 MHz	
Stored	

No frequency → 1 Squelch: Middle ...

Instruction Manual

Sync

4

SYNC

≤ 10 cm

≤ 4"

OR

OR

✓ SYNC

✗ SYNC

Instruction Manual

Multichannel - Easy Setup

Bank 1...20; U

Channel 1...12

max. 12 channels

>12 channels → Instruction Manual

RJ 10

Instruction Manual

Sensitivity

5

Menu Sensitivity Δ/∇ SET

-24dB

-60 dB ... 0 dB

-48 dB ... 0 dB

AF PEAK

Instruction Manual

AF out

6

Menu AF Out Δ/∇ SET

+18 dB

LEVEL

-24 dB ... +24 dB

Instruction Manual

SKM

ME 2 | ME 4

ME 2

25 cm (10")

ME 4

ME 3-II

2...3 cm (1")

ME 2 | ME 4

ME 2

25 cm (10")

ME 4

ME 3-II

2...3 cm (1")